

Construction characteristics

End plates	UNI 5079 aluminium alloy casting painted black by cataphoresis
Rod	C43 chromed steel Ra = 0.2
Barrel	UNI 9006/1 aluminium alloy square section, hardened 30 micron oxidate
Cushion bushings	2011 UNI 9002/5 hardened alloy aluminium
Piston	polyacetal resin, self-lubricated and anti-wear, with plastroferrite rings in magnetic version
Piston seals	NBR oil-resistant rubber, PUR Piston rod and cushion seals
Cushioning adjustment screw	brass

Technical characteristics

Fluid	filtered and lubricated air
Pressure	10 bar
Operating temperature	5°C - +70°C

Please follow the suggestions below to ensure a long life for these cylinders:

- use clean and lubricated air
- correct alignment during assembly with regard to the applied load so as to avoid radial components or bending the rod.
- avoid high speeds together with long strokes and heavy loads: this would produce kinetic energy which the cylinder cannot absorb, especially if used as a limit stop (in this case use mechanical stop device)
- evaluate the environmental characteristics of cylinder used (high temperature, hard atmosphere, dust, humidity etc.)

Please note: air must be dried for applications with lower temperature.

Use hydraulic oils H class (ISO Vg32) for correct continued lubrication.

Our Technical Department will be glad to help.

Bore	Usable surface (square profile) cm ²	Max couple on the rod (max torque) Nm	Grade precision (rest rod, without load) anti-rotation	Cushion length mm.
32	8.31	0.5	12'	22
40	12.41	0.8	12'	27
50	18.41	1.1	12'	27
63	29.67	1.5	12'	32

Standard strokes (for all diameters)

from 0 to 150, every 25 mm

Other stroke for these following bores:

Ø 32 80 mm
Ø 40 80 - 160 mm
Ø 50 80 - 160 - 200 - 250 mm
Ø 63 80 - 160 - 200 - 300 - 320 mm

Stroke Tolerance (ISO 15552)

Bore	Stroke	Tolerance
32 - 40 - 50 - 63	up to 500	$\begin{matrix} +2 \\ 0 \end{matrix}$



Basic version

Ordering code

1348.Ø.stroke.01
magnetic chromed rod
1349.Ø.stroke.01
magnetic stainless
steel rod
1350.Ø.stroke.01
non-magnetic
chromed rod

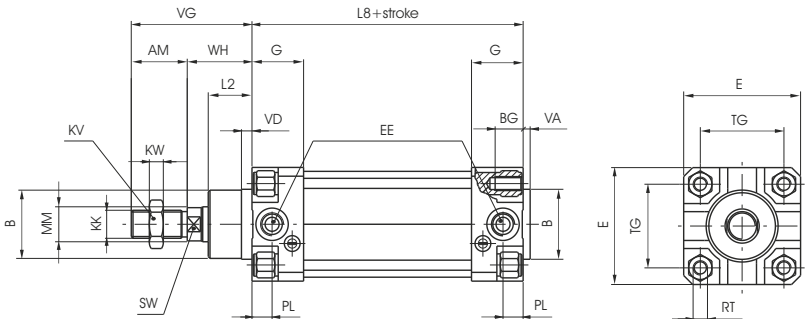

This is the configuration that represents the basic cylinder according to ISO standards. It can be directly anchored on machine parts using the four threads on the end cover. For other applications see the following pages where different types of attachments shown.

Bore	32	40	50	63	
AM	22	24	32	32	
B (d 11)	30	35	40	45	
BG	12	12	16	16	
E	46	52	65	75	
EE	G 1/8"	G 1/4"	G 1/4"	G 3/8"	
G	25	29	29.5	36	
KK	M10x1.25	M12x1.25	M16x1.5	M16x1.5	
KV	17	19	24	24	
KW	6	7	8	8	
L 2	16	20	25	25	
L 8	94	105	106	121	
MM	12	16	20	20	
PL	9	11.5	13	14	
RT	M6	M6	M8	M8	
SW	10	13	17	17	
TG	32.5	38	46.5	56.5	
VA	4	4	4	4	
VD	5	6	6	6	
VG	48	54	69	69	
WH	26	30	37	37	
Weight	stroke 0	505	705	1320	1710
gr.	every 10 mm	24	33	53	58

Push/pull version

Ordering code

1348.Ø.stroke.02
magnetic chromed rod
1349.Ø.stroke.02
magnetic stainless
steel rod
1350.Ø.stroke.02
non-magnetic
chromed rod

